

## FEATURES

- \* WATTAGES FROM 0.25 WATTS TO 2 WATTS
- \* RANGE FROM 0.1 OHM TO 100K OHM
- \* ALL WELDED CONSTRUCTION
- \* SILICONE / FLAME RETARDANT COATED
- \* NON - INDUCTIVE ARYTON - PERRY WINDING TYPE AVAILABLE
- \* ANY SPECIAL DESIGN ON REQUEST



## CHARACTERISTICS

Tolerance	±0.5%	0R1 - 0R9
	±0.1%	1R - 99R9
	±0.05%	100R - 100K
	±0.01%	100R - 100K
Temperature coefficient	±10PPM/°C	
Power dissipation	Rated at 40°C and derate linearly to 0 power at 155°C	
Load life stability	±0.01% (after full load dissipation for 1000 hrs.)	

## DIMENSIONS(mm)

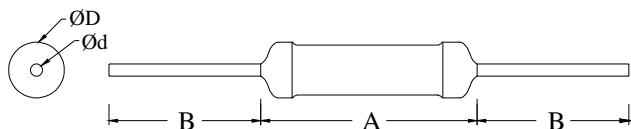

## DERATING CURVE

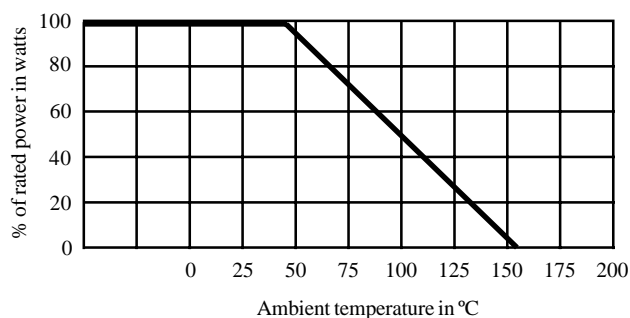

## TECHNICAL SPECIFICATIONS

Type no.	Wattage at 40°C.	Ohmic range		Mechanical dimensions.(mm)			
		Min	Max	A±2.0	ØD±0.5	B±1.0	Ød±0.1
VPP0.25	0.25	0R1	6K2	12	4	35	0.8
VPP0.5	0.5	0R1	20K	18	6	30	0.8
VPP1	1.0	0R1	68K	37	8	35	0.8
VPP2	2.0	0R1	100K	52	8	35	0.8