

FEATURES

- * FLAT TYPE CONSTRUCTION
- * FLAME PROOF PROTECTION
- * EASY MOUNTING ARRANGEMENT

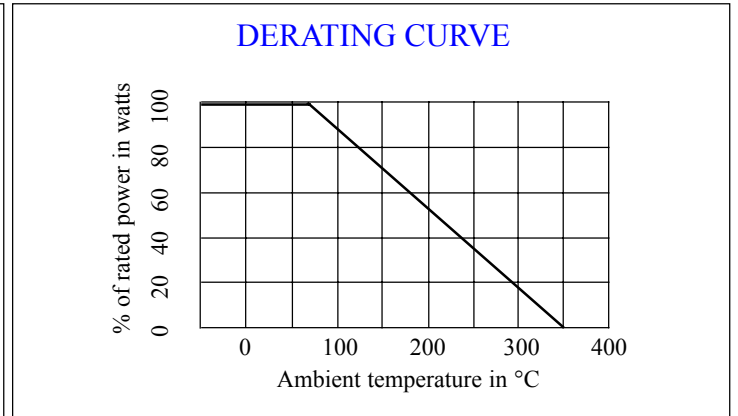
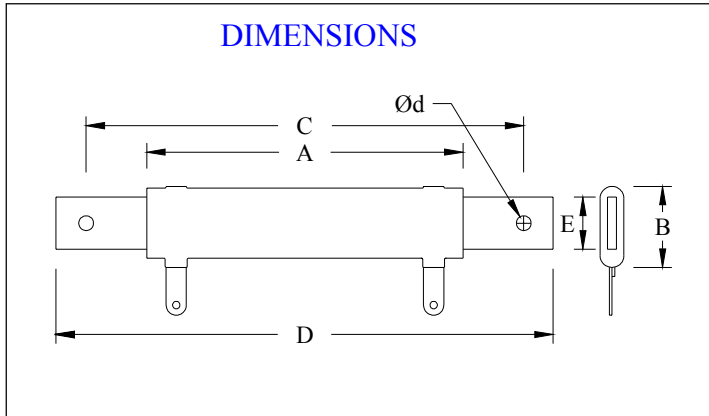

TECHNICAL SPECIFICATIONS

Type	Watts at 70°C	Ohmic range		Mechanical Dimensions				
		Min	Max	A±2.0	B±1.0	C±0.5	D±0.5	E±1.0
VPF-25	25W	0R1	3K3	50	19	59.0	74.0	10
VPF-30	30W	0R1	4K7	50	27	70.0	85.0	17
VPF-50	50W	0R3	10K	90	27	110.0	25.0	17
VPF-90	90W	0R5	18K	150	27	170.0	185.0	17